



Fitting **SMART**



E.M.T. STRAP ONE HOLE - STEEL



CATALOG NUMBER	TRADE SIZE	INNER CARTON	MASTER CARTON
62021	1/2"	100	1000
62022	3/4"	100	500
62023	1"	50	500
62024	1 1/4"	20	100
62025	1 1/2"	-	50
62026	2"	-	20
62027	2 1/2"	-	25
62028	3"	-	25
62029	3 1/2"	-	10
62030	4"	-	10

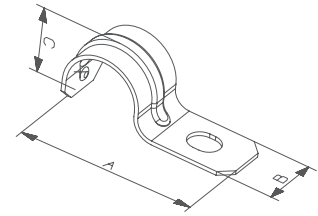

CAT#	A	B	C
62021	1.657	0.571	0.665
62022	1.937	0.646	0.933
62023	2.276	0.772	1.110
62024	2.858	0.878	1.480
62025	3.126	1.000	1.673
62026	3.921	1.138	2.020
62027	5.012	1.173	2.602
62028	5.374	1.215	3.291
62029	6.390	1.254	4.248
62030	6.850	1.157	4.177

E.M.T. STRAP - TWO HOLES - STEEL



CATALOG NUMBER	TRADE SIZE	INNER CARTON	MASTER CARTON
62121	1/2"	100	1000
62122	3/4"	100	500
62123	1"	50	500
62124	1 1/4"	20	100
62125	1 1/2"	-	50
62126	2"	-	20
62127	2 1/2"	-	25
62128	3"	-	25
62129	3 1/2"	-	10
62130	4"	-	10

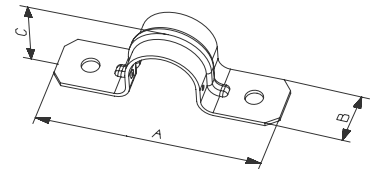

CAT#	A	B	C
62121	2.240	0.574	0.732
62122	2.756	0.636	0.965
62123	3.252	0.713	1.157
62124	3.831	0.748	1.453
62125	4.323	0.791	1.957
62126	4.925	1.004	2.205
62127	6.106	1.004	2.969
62128	6.772	1.004	3.539
62129	7.425	1.004	4.110
62130	9.366	1.016	4.508

HANGERS FOR RIGID CONDUIT, IMC CONDUIT & E.M.T. - WITH BOLTS(ASSEMBLED) - STEEL



CATALOG NUMBER	TRADE SIZE	INNER CARTON	MASTER CARTON
62501	1/2"	50	500
62502	3/4"	-	50
62503	1"	-	50
62504	1 1/4"	-	50
62505	1 1/2"	-	50
62506	2"	-	25
62507	2 1/2"	-	25
62508	3"	-	25
62509	3 1/2"	-	10
62510	4"	-	10

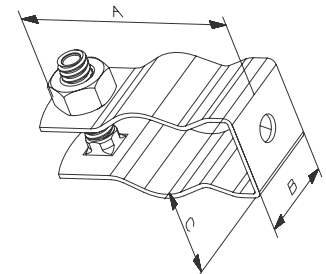

CAT#	A	B	C
62501	1.929	0.752	0.752
62502	2.280	0.886	0.945
62503	2.516	0.886	0.913
62504	3.024	0.886	1.051
62505	3.386	0.967	1.126
62506	4.213	1.185	1.386
62507	4.882	1.228	1.098
62508	5.276	1.220	1.244
62509	5.750	1.250	1.275
62510	6.591	1.154	1.114

FLEXIBLE METAL CONDUIT SQUEEZE CONNECTOR - ZINC DIE CAST



E315258 3/8" - 3/4"
E315256 1" - 4"

CATALOG NUMBER	TRADE SIZE	INNER CARTON	MASTER CARTON
82059	3/8"	50	500
82060	1/2"	25	250
82061	3/4"	25	250
82062	1"	10	100
82063	1-1/4"	10	100
82064	1-1/2"	5	50
82065	2"	10	40
82066	2-1/2"	10	10
82067	3"	10	10
82068	3-1/2"	-	1
82069	4"	-	1

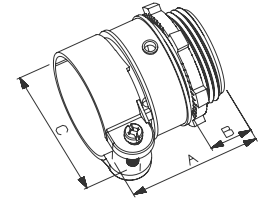

CAT#	A	B	C
82059	1.146	0.512	1.141
82060	1.437	0.492	1.370
82061	1.575	0.476	1.574
82062	1.760	0.571	1.866
82063	1.874	0.587	2.145
82064	2.008	0.610	2.519
82065	2.087	0.606	3.011
82066	2.854	0.866	3.866
82067	2.236	0.866	4.354
82068	3.840	0.902	4.788
82069	4.055	0.902	5.303

FLEXIBLE METAL CONDUIT SQUEEZE CONNECTOR WITH INSULATED THROAT - ZINC DIE CAST



E315258 3/8" - 3/4"
E315256 1" - 4"

CATALOG NUMBER	TRADE SIZE	INNER CARTON	MASTER CARTON
82059-A	3/8"	50	500
82060-A	1/2"	25	250
82061-A	3/4"	25	250
82062-A	1"	10	100
82063-A	1-1/4"	10	100
82064-A	1-1/2"	5	50
82065-A	2"	10	40
82066-A	2-1/2"	10	10
82067-A	3"	10	10
82068-A	3-1/2"	-	1
82069-A	4"	-	1

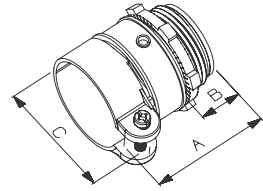

CAT#	A	B	C
82059-A	1.206	0.572	1.141
82060-A	1.497	0.552	1.370
82061-A	1.635	0.536	1.574
82062-A	1.820	0.631	1.866
82063-A	1.954	0.667	2.145
82064-A	2.934	0.690	2.519
82065-A	2.167	0.686	3.011
82066-A	2.954	0.966	3.866
82067-A	0.336	0.966	4.354
82068-A	3.940	1.002	4.788
82069-A	4.155	1.002	5.303

DUPLEX CONNECTORS - ZINC DIE CAST



E315258

CATALOG NUMBER	TRADE SIZE	INNER CARTON	MASTER CARTON
84001	3/8"	25	250

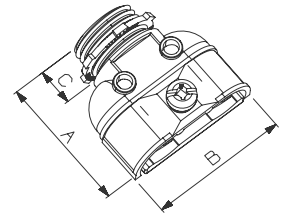

CAT#	A	B	C
84001	1.591	1.622	0.457

DUPLEX CONNECTORS - ONE SCREW - ZINC DIE CAST



E315258

CATALOG NUMBER	TRADE SIZE	INNER CARTON	MASTER CARTON
84002	3/8"	25	250

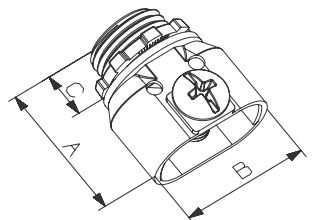

CAT#	A	B	C
84002	1.402	1.323	0.472

COMBINATION COUPLINGS - EMT TO ROMEX & FLEX - ZINC DIE CAST



CATALOG NUMBER	TRADE SIZE	INNER CARTON	MASTER CARTON
82042	1/2"	50	500

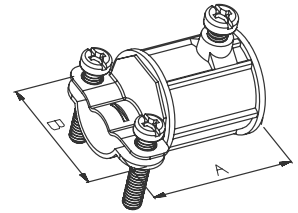

CAT#	A	B
82042	1.318	1.173

COMBINATION COUPLINGS (E.M.T. TO FLEXIBLE CONDUIT) - ZINC DIE CAST

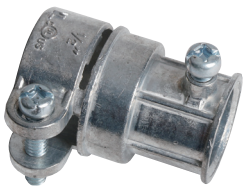

CATALOG NUMBER	TRADE SIZE	INNER CARTON	MASTER CARTON
82043	1/2" TO 1/2"	25	250
82044	3/4" TO 3/4"	25	250

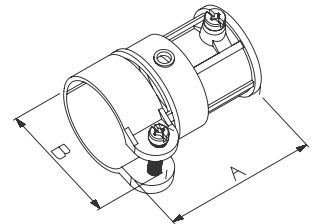

CAT#	A	B
82043	1.646	1.417
82044	1.972	1.547

PULL ELBOWS - EMT TO EMT - ZINC DIE CAST



CATALOG NUMBER	TRADE SIZE	INNER CARTON	MASTER CARTON
85088	1/2"	10	100
85089	3/4"	5	50
85090	1"	-	25
85091	1 1/4"	-	20

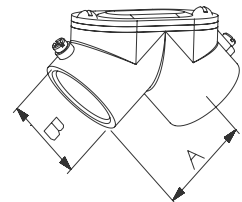

CAT#	A	B
85088	1.311	0.961
85089	1.385	1.230
85090	1.961	1.516
85091	2.303	1.890

PULL ELBOWS - EMT TO BOX - ZINC DIE CAST



CATALOG NUMBER	TRADE SIZE	INNER CARTON	MASTER CARTON
85301	1/2"	10	100
85302	3/4"	5	50
85303	1"	-	25
85304	1 1/4"	-	20

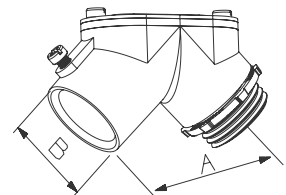

CAT#	A	B
85301	1.311	0.961
85302	1.385	1.230
85303	1.961	1.516
85304	2.303	1.890

90° COMPRESSION ELBOWS - ZINC DIE CAST

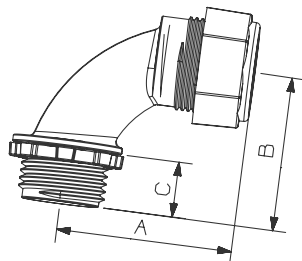

CATALOG NUMBER	TRADE SIZE	INNER CARTON	MASTER CARTON
02805	1/2"	-	-
02807	3/4"	-	-



CAT#	A	B	C
02805	1.595	1.451	0.521
02807	1.882	1.675	0.521



EMT CONNECTORS - SET SCREW TYPE - ALUMINUM

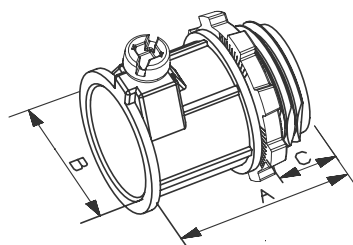

CATALOG NUMBER	TRADE SIZE	INNER CARTON	MASTER CARTON
88036-AL	1/2"	50	500
88037-AL	3/4"	25	250
88038-AL	1"	50	200
88039-AL	1-1/4"	-	25
88040-AL	1-1/2"	-	25
88041-AL	2"	-	20
88042-AL	2 1/2"	-	12
88043-AL	3"	-	12
88044-AL	3 1/2"	-	10
88045-AL	4"	-	6



CAT#	A	B	C
88036-AL	1.161	0.929	0.394
88037-AL	1.346	1.161	0.354
88038-AL	1.500	1.406	0.488
88039-AL	1.961	1.803	0.591
88040-AL	2.264	2.059	0.748
88041-AL	2.575	2.520	0.760
88042-AL	3.090	3.295	1.047
88043-AL	3.374	3.909	1.059
88044-AL	3.460	4.460	1.059
88045-AL	3.759	4.881	1.110



EMT COUPLING - SET SCREW TYPE - ALUMINUM

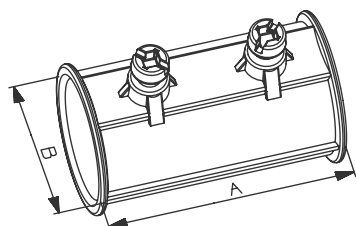

CATALOG NUMBER	TRADE SIZE	INNER CARTON	MASTER CARTON
88062-AL	1/2"	50	500
88063-AL	3/4"	25	250
88064-AL	1"	50	200
88065-AL	1-1/4"	-	25
88066-AL	1-1/2"	-	25
88067-AL	2"	-	20
88068-AL	2 1/2"	-	12
88069-AL	3"	-	12
88070-AL	3 1/2"	-	10
88071-AL	4"	-	6



CAT#	A	B
88062-AL	1.496	0.886
88063-AL	1.961	1.181
88064-AL	2.276	1.402
88065-AL	2.618	1.822
88066-AL	2.937	2.094
88067-AL	3.476	2.515
88068-AL	4.011	3.303
88069-AL	4.460	3.913
88070-AL	4.850	4.520
88071-AL	5.248	4.909



EMT CONNECTORS - SET SCREW TYPE - ZINC DIE CAST



E315281 1/2" - 2"
E315256 2 1/2" - 4"

CATALOG NUMBER	TRADE SIZE	INNER CARTON	MASTER CARTON
88036	1/2"	50	500
88037	3/4"	25	250
88038	1"	50	200
88039	1-1/4"	-	25
88040	1-1/2"	-	25
88041	2"	-	20
88042	2 1/2"	-	12
88043	3"	-	12
88044	3 1/2"	-	10
88045	4"	-	6

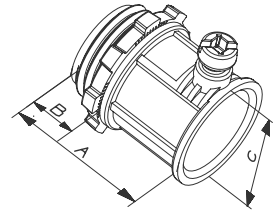

CAT#	A	B	C
88036	1.157	0.382	0.933
88037	1.378	0.366	1.169
88038	1.504	0.500	1.421
88039	1.969	1.535	1.823
88040	2.260	1.768	2.067
88041	2.563	2.228	2.524
88042	3.090	1.047	3.295
88043	3.374	1.059	3.909
88044	3.460	1.059	4.460
88045	3.759	1.110	4.881

EMT CONNECTOR - SET SCREW WITH INSULATED THROAT - ZINC DIE CAST



E315256 2 1/2" - 4"

CATALOG NUMBER	TRADE SIZE	INNER CARTON	MASTER CARTON
88036-A	1/2"	50	500
88037-A	3/4"	25	250
88038-A	1"	50	200
88039-A	1 1/4"	-	25
88040-A	1 1/2"	-	25
88041-A	2"	-	20
88042-A	2 1/2"	-	12
88043-A	3"	-	12
88044-A	3 1/2"	-	10
88045-A	4"	-	6

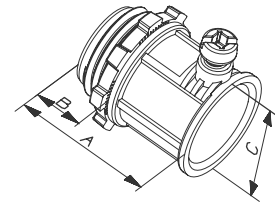

CAT#	A	B	C
88036-A	1.196	0.421	0.933
88037-A	1.417	0.405	1.169
88038-A	1.543	0.539	1.421
88039-A	2.008	1.574	1.823
88040-A	2.299	1.807	2.067
88041-A	2.602	2.267	2.524
88042-A	3.149	1.106	3.295
88043-A	3.433	1.118	3.909
88044-A	3.519	1.118	4.460
88045-A	3.818	1.169	4.881

EMT COUPLING - SET SCREW TYPE - ZINC DIE CAST



E315281 1/2" - 2"
E315256 2 1/2" - 4"

CATALOG NUMBER	TRADE SIZE	INNER CARTON	MASTER CARTON
88062	1/2"	50	500
88063	3/4"	25	250
88064	1"	50	200
88065	1-1/4"	-	25
88066	1-1/2"	-	25
88067	2"	-	20
88068	2 1/2"	-	12
88069	3"	-	12
88070	3 1/2"	-	10
88071	4"	-	6

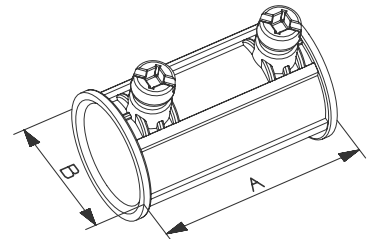

CAT#	A	B
88062	1.488	0.905
88063	1.944	1.177
88064	2.275	1.413
88065	2.618	1.822
88066	2.909	2.039
88067	3.476	2.515
88068	4.011	3.303
88069	4.460	3.913
88070	4.850	4.520
88071	5.248	4.909

CONDUIT BODIES FOR E.M.T. SET SCREW TYPE - ALUMINUM



UL US
E315256

CATALOG NUMBER	TRADE SIZE	INNER CARTON	MASTER CARTON
LB-50AE	1/2"	10	50
LB-75AE	3/4"	5	50
LB-100AE	1"	4	20
LB-125AE	1-1/4"	-	10
LB-150AE	1-1/2"	-	10
LB-200AE	2"	-	5
LB-250AE	2-1/2"	-	1
LB-300AE	3"	-	1
LB-350AE	3-1/2"	-	1
LB-400AE	4"	-	1

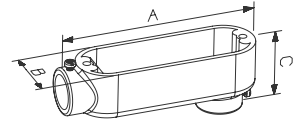

CAT#	A	B	C
LB-50AE	4.359	1.330	2.060
LB-75AE	4.972	1.552	2.370
LB-100AE	5.819	1.747	2.630
LB-125AE	7.795	2.491	3.500
LB-150AE	7.807	2.491	3.750
LB-200AE	9.850	3.123	4.310
LB-250AE	12.673	4.444	4.450
LB-300AE	12.583	4.459	4.450
LB-350AE	15.661	5.590	5.800
LB-400AE	15.661	5.590	5.800



UL US
E315256

CATALOG NUMBER	TRADE SIZE	INNER CARTON	MASTER CARTON
LL-50AE	1/2"	10	50
LL-75AE	3/4"	5	50
LL-100AE	1"	4	20
LL-125AE	1-1/4"	-	10
LL-150AE	1-1/2"	-	10
LL-200AE	2"	-	5
LL-250AE	2-1/2"	-	1
LL-300AE	3"	-	1
LL-350AE	3-1/2"	-	1
LL-400AE	4"	-	1

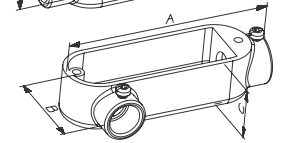
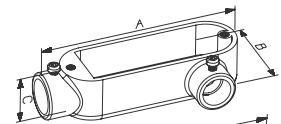

CAT#	A	B	C
LL/LR-50AE	4.359	2.015	1.412
LL/LR-75AE	4.972	2.299	1.655
LL/LR-100AE	5.819	2.427	1.894
LL/LR-125AE	7.795	3.391	2.685
LL/LR-150AE	7.807	3.412	2.685
LL/LR-200AE	9.850	4.082	3.425
LL/LR-250AE	12.673	5.878	3.984
LL/LR-300AE	12.583	5.898	4.448
LL/LR-350AE	15.661	7.681	5.559
LL/LR-400AE	15.661	7.681	5.559



UL US
E315256

CATALOG NUMBER	TRADE SIZE	INNER CARTON	MASTER CARTON
LR-50AE	1/2"	10	50
LR-75AE	3/4"	5	50
LR-100AE	1"	4	20
LR-125AE	1-1/4"	-	10
LR-150AE	1-1/2"	-	10
LR-200AE	2"	-	5
LR-250AE	2-1/2"	-	1
LR-300AE	3"	-	1
LR-350AE	3-1/2"	-	1
LR-400AE	4"	-	1

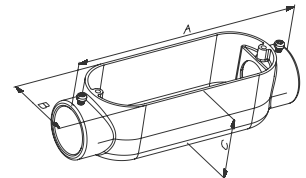

UL US
E315256

CATALOG NUMBER	TRADE SIZE	INNER CARTON	MASTER CARTON
C-50AE	1/2"	10	50
C-75AE	3/4"	5	50
C-100AE	1"	4	20
C-125AE	1-1/4"	-	10
C-150AE	1-1/2"	-	10
C-200AE	2"	-	5
C-250AE	2-1/2"	-	1
C-300AE	3"	-	1
C-350AE	3-1/2"	-	1
C-400AE	4"	-	1

CAT#	A	B	C
C-50AE	4.825	1.330	1.412
C-75AE	5.646	1.552	1.655
C-100AE	6.467	1.747	1.894
C-125AE	8.268	2.491	2.685
C-150AE	8.268	2.491	2.685
C-200AE	10.232	3.123	3.425
C-250AE	13.102	4.444	3.984
C-300AE	13.067	4.459	4.448
C-350AE	16.236	5.590	5.559
C-400AE	16.236	5.590	5.559



UL US
E315256

CATALOG NUMBER	TRADE SIZE	INNER CARTON	MASTER CARTON
T-50AE	1/2"	10	50
T-75AE	3/4"	5	50
T-100AE	1"	4	20
T-125AE	1-1/4"	-	10
T-150AE	1-1/2"	-	10
T-200AE	2"	-	5
T-250AE	2-1/2"	-	1
T-300AE	3"	-	1
T-350AE	3-1/2"	-	1
T-400AE	4"	-	1

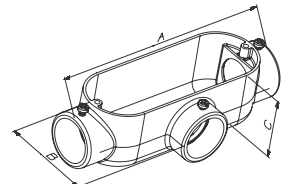

CAT#	A	B	C
T-50AE	4.825	2.089	1.412
T-75AE	5.646	2.241	1.655
T-100AE	6.467	2.523	1.894
T-125AE	8.268	3.450	2.685
T-150AE	8.268	3.460	2.685
T-200AE	10.232	4.089	3.425
T-250AE	13.102	5.850	3.984
T-300AE	13.067	5.850	4.448
T-350AE	16.236	7.648	5.559
T-400AE	16.236	7.648	5.559

GALVANIZED STEEL CONDUIT

CATALOG NUMBER	TRADE SIZE	OUTSIDE (MM)	THICKNESS (MM)
98401	3/8"	-	0.21
98402	1/2"	-	0.22
98403	3/4"	-	0.23
98404	1"	-	0.26
98405	1-1/4"	-	0.33
98406	1-1/2"	-	0.33
98407	2"	-	0.36
98408	2-1/2"	-	0.5
98409	3"	-	0.5
98410	3-1/2"	-	0.55
98411	4"	-	0.55



STEEL FLEXIBLE CONDUIT

CATALOG NUMBER	TRADE SIZE	INTERNAL DIAMETER Min/Max (MM)	EXTERNAL DIAMETER Min/Max (MM)
98501	3/8"	9.52/9.98	14.22/15.49
98502	1/2"	15.87/16.38	21.84/23.36
98503	3/4"	21.62/21.20	26.54/28.06
98504	1"	25.4/26.4	33.02/35.05
98505	1-1/4"	31.75/33.02	39.37/41.40
98506	1-1/2"	38.10/40.0	46.99/49.53
98507	2"	50.8/52.83	59.69/62.23
98508	2-1/2"	63.5/-	72.64/77.72
98509	3"	76.2/-	85.34/90.42
98510	3-1/2"	88.9/-	98.04/103.12
98511	4"	101.6/-	110.74/115.84



PVC COATED FLEXIBLE STEEL CONDUIT

CATALOG NUMBER	TRADE SIZE	OUTSIDE (MM)	THICKNESS (MM)
98601	3/8"	-	0.21
98602	1/2"	-	0.22
98603	3/4"	-	0.23
98604	1"	-	0.26
98605	1-1/4"	-	0.33
98606	1-1/2"	-	0.33
98607	2"	-	0.36
98608	2-1/2"	-	0.5
98609	3"	-	0.5
98610	3-1/2"	-	0.55
98611	4"	-	0.55



LIQUID-TIGHT CONNECTORS - 90° ANGLE - ZINC DIE CAST

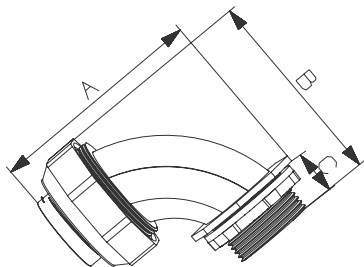

CAT#	A	B	C
85001	2.402	2.204	0.511
85002	2.433	2.153	0.511
85003	2.717	2.519	0.563
85004	3.425	2.885	0.720
85005	3.976	3.220	0.838
85006	4.122	3.700	0.708
85007	4.701	4.184	0.680
85008	6.189	5.149	1.043
85009	7.087	6.133	0.964
85010	7.450	6.715	1.100
85011	8.531	7.405	1.027

CATALOG NUMBER	TRADE SIZE	INNER CARTON	MASTER CARTON
85001	3/8"	10	100
85002	1/2"	10	100
85003	3/4"	10	100
85004	1"	5	50
85005	1-1/4"	2	20
85006	1-1/2"	2	20
85007	2"	1	10
85008	2-1/2"	-	1
85009	3"	-	1
85010	3-1/2"	-	1
85011	4"	-	1



LIQUID-TIGHT CONNECTORS - 90° ANGLE - INSULATION - ZINC DIE CAST

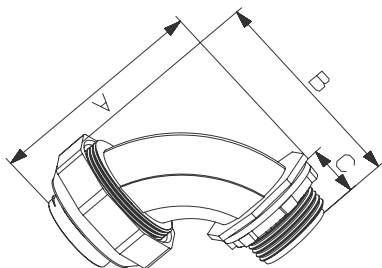

CAT#	A	B	C
85001-A	2.402	2.244	0.551
85002-A	2.433	2.193	0.551
85003-A	2.717	2.559	0.603
85004-A	3.425	2.925	0.760
85005-A	3.976	3.260	0.878
85006-A	4.122	3.740	0.748
85007-A	4.701	4.224	0.720
85008-A	6.189	5.189	1.083
85009-A	7.087	6.173	1.004
85010-A	7.529	6.715	1.100
85011-A	8.531	7.445	1.067

CATALOG NUMBER	TRADE SIZE	INNER CARTON	MASTER CARTON
85001-A	3/8"	10	100
85002-A	1/2"	10	100
85003-A	3/4"	10	100
85004-A	1"	5	50
85005-A	1-1/4"	2	20
85006-A	1-1/2"	2	20
85007-A	2"	1	10
85008-A	2-1/2"	-	1
85009-A	3"	-	1
85010-A	3-1/2"	-	1
85011-A	4"	-	1



90° LIQUID-TIGHT CONNECETORS - NYLON

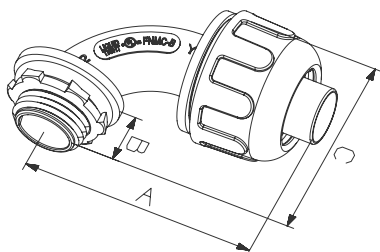

CAT#	A	B	C
P490	2.840	0.500	2.030
P491	2.840	0.500	2.030
P492	3.250	0.500	2.330
P493	3.540	0.600	2.950
P494	4.750	0.760	5.200
P495	4.750	0.800	5.200
P496	5.420	0.860	5.800

CATALOG NUMBER	TRADE SIZE	INNER CARTON	MASTER CARTON
P490	3/8"	10	100
P491	1/2"	10	100
P492	3/4"	10	100
P493	1"	5	50
P494	1-1/4"	2	20
P495	1-1/2"	2	20
P496	2"	1	10



LIQUID-TIGHT CONNECTORS - STRAIGHT - ZINC DIE CAST



CATALOG NUMBER	TRADE SIZE	INNER CARTON	MASTER CARTON
88115	3/8"	20	200
88116	1/2"	20	200
88117	3/4"	10	100
88118	1"	5	50
88119	1-1/4"	5	50
88120	1-1/2"	2	20
88121	2"	2	20
88122	2-1/2"	-	1
88123	3"	-	1
88124	3-1/2"	-	1
88125	4"	-	1

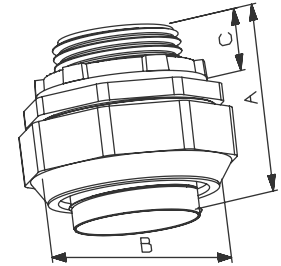

CAT#	A	B	C
88115	1.444	1.299	0.543
88116	1.444	1.307	0.551
88117	1.448	1.583	0.551
88118	1.810	1.780	0.716
88119	2.031	1.909	0.716
88120	1.991	2.488	0.716
88121	2.007	2.992	0.684
88122	3.279	3.709	0.984
88123	3.440	4.331	1.011
88124	5.470	3.660	0.920
88125	3.984	5.173	1.035

LIQUID-TIGHT CONNECTORS - STRAIGHT WITH INSULATED THROAT - ZINC DIE CAST



CATALOG NUMBER	TRADE SIZE	INNER CARTON	MASTER CARTON
88115-A	3/8"	20	200
88116-A	1/2"	20	200
88117-A	3/4"	10	100
88118-A	1"	5	50
88119-A	1-1/4"	5	50
88120-A	1-1/2"	2	20
88121-A	2"	2	20
88122-A	2-1/2"	-	1
88123-A	3"	-	1
88124-A	3-1/2"	-	1
88125-A	4"	-	1

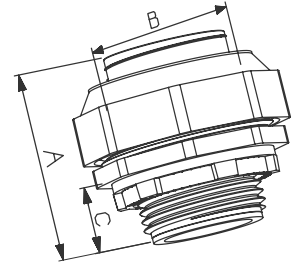

CAT#	A	B	C
88115-A	1.484	1.299	0.583
88116-A	1.484	1.307	0.591
88117-A	1.488	1.583	0.591
88118-A	1.850	1.780	0.756
88119-A	2.071	1.909	0.756
88120-A	2.031	2.488	0.756
88121-A	2.047	2.992	0.724
88122-A	3.319	3.709	1.024
88123-A	3.480	4.331	1.051
88124-A	5.550	3.660	0.920
88125-A	4.024	5.173	1.075

LIQUID-TIGHT CONNECTORS - NYLON



CATALOG NUMBER	TRADE SIZE	INNER CARTON	MASTER CARTON
P470	3/8"	20	200
P471	1/2"	20	200
P472	3/4"	10	100
P473	1"	5	50
P474	1-1/4"	5	50
P475	1-1/2"	2	20
P476	2"	2	20

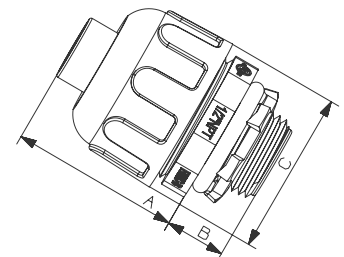

CAT#	A	B	C
P470	1.180	0.550	1.420
P471	1.180	0.550	1.420
P472	1.200	0.640	1.690
P473	1.230	0.720	2.020
P474	2.440	0.760	2.400
P475	2.700	0.800	2.670
P476	2.990	0.850	3.280

LIQUID-TIGHT COVERED STEEL FLEXIBLE CONDUIT

CATALOG NUMBER	TRADE SIZE	INTERNAL DIAMETER Min/Max (MM)	EXTERNAL DIAMETER Min/Max (MM)
98701	3/8"	12.3/12.8	17.5/18.0
98702	1/2"	15.8/16.3	20.8/21.3
98703	3/4"	20.7/21.2	26.2/26.7
98704	1"	26.4/26.8	32.7/33.4
98705	1-1/4"	35.05/35.4	41.4/42.2
98706	1-1/2"	40.1/40.6	47.4/48.3
98707	2"	51.3/51.9	59.4/60.3
98708	2-1/2"	63.0/63.6	72.1/73.0
98709	3"	78.0/78.8	87.9/88.9
98710	4"	101.6/102.6	113.2/114.3



90° LIQUID-TIGHT CONNECTORS ZINC DIE CAST

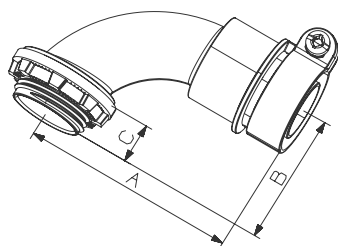

CATALOG NUMBER	TRADE SIZE	INNER CARTON	MASTER CARTON
06805	1/2"	10	100
06807	3/4"	10	100



CAT#	A	B	C
06805	2.470	1.520	0.521
06807	2.761	1.695	0.521



LIQUID-TIGHT CONNECTORS ZINC DIE CAST

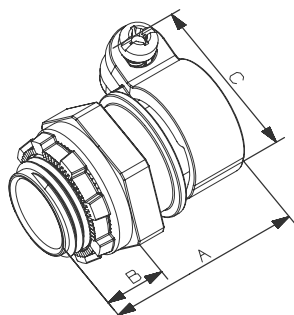

CATALOG NUMBER	TRADE SIZE	INNER CARTON	MASTER CARTON
06305	1/2"	10	100
06307	3/4"	10	100



CAT#	A	B	C
06305	1.661	0.521	1.543
06307	1.721	0.521	1.790



CONDUIT LOCKNUTS - ZINC DIE CAST

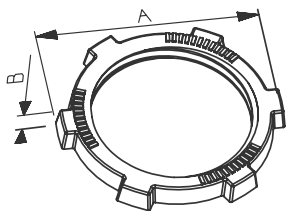

CAT#	A	B
82201	1.087	0.122
82202	1.358	0.142
82203	1.661	0.157
82204	2.047	0.157
82205	2.366	0.181
82206	2.929	0.187
82207	3.449	0.248
82208	4.189	0.232
82209	4.646	0.283
82210	5.146	0.240

CATALOG NUMBER	TRADE SIZE	INNER CARTON	MASTER CARTON
82201	1/2"	200	2000
82202	3/4"	100	1000
82203	1"	100	1000
82204	1 1/4"	50	500
82205	1 1/2"	50	500
82206	2"	20	200
82207	2 1/2"	25	100
82208	3"	25	100
82209	3 1/2"	10	40
82210	4"	10	40

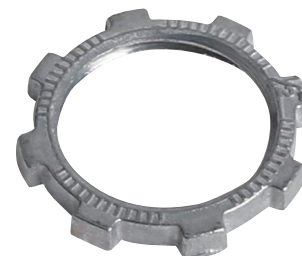

CONDUIT LOCKNUTS - STEEL

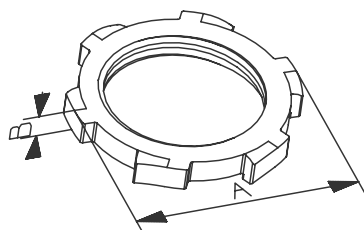

CAT#	A	B
62201	1.134	0.106
62202	1.390	0.118
62203	1.709	0.154
62204	2.059	0.154
62205	2.358	0.154
62206	2.858	0.157
62207	3.429	0.197
62208	4.110	0.197
62209	4.693	0.209
62210	5.256	0.217
62211	6.496	0.433
62212	7.795	0.433

CATALOG NUMBER	TRADE SIZE	INNER CARTON	MASTER CARTON
62201	1/2"	100	1000
62202	3/4"	100	1000
62203	1"	100	1000
62204	1 1/4"	50	500
62205	1 1/2"	50	500
62206	2"	25	250
62207	2 1/2"	25	250
62208	3"	-	25
62209	3 1/2"	-	25
62210	4"	-	15
62211	5"	-	10
62212	6"	-	10



STEEL SEALING LOCKNUTS WITH PLASTIC SEAL

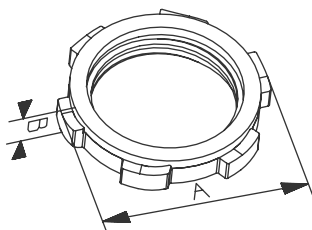

CAT#	A	B
82201-A	1.134	0.260
82202-A	1.390	0.270
82203-A	1.709	0.280
82204-A	2.059	0.320
82205-A	2.358	0.320
82206-A	2.858	0.320
82207-A	3.429	0.320
82208-A	4.110	0.320
82209-A	4.693	0.320
82210-A	5.256	0.320

CATALOG NUMBER	TRADE SIZE	INNER CARTON	MASTER CARTON
82201-A	1/2"	50	500
82202-A	3/4"	50	500
82203-A	1"	25	250
82204-A	1 1/4"	10	100
82205-A	1 1/2"	10	100
82206-A	2"	10	100
82207-A	2 1/2"	-	25
82208-A	3"	-	25
82209-A	3 1/2"	-	25
82210-A	4"	-	25



STEEL BONDING LOCKNUTS



CATALOG NUMBER	TRADE SIZE	INNER CARTON	MASTER CARTON
62201-G	1/2"	100	1000
62202-G	3/4"	100	1000
62203-G	1"	50	500
62204-G	1 1/4"	50	500
62205-G	1 1/2"	25	250
62206-G	2"	25	250
62207-G	2 1/2"	-	25
62208-G	3"	-	25
62209-G	3 1/2"	-	25
62210-G	4"	-	25

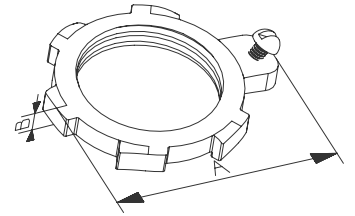

CAT#	A	B
62201-G	1.150	0.110
62202-G	1.450	0.115
62203-G	1.750	0.140
62204-G	2.100	0.140
62205-G	2.400	0.140
62206-G	2.950	0.140
62207-G	3.550	0.185
62208-G	3.550	0.190
62209-G	4.200	0.190
62210-G	4.750	0.190

INSULATED METALLIC GROUNDING BUSHINGS - ZINC DIE CAST



CATALOG NUMBER	TRADE SIZE	INNER CARTON	MASTER CARTON
88351-G	1/2"	25	250
88352-G	3/4"	25	250
88353-G	1"	25	250
88354-G	1 1/4"	10	100
88355-G	1 1/2"	10	100
88356-G	2"	10	100
88357-G	2 1/2"	5	50
88358-G	3"	5	50
88359-G	3 1/2"	2	20
88360-G	4"	2	20

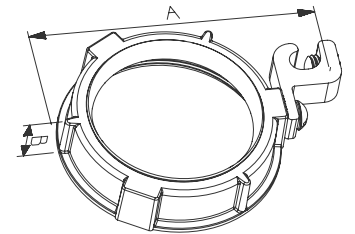

CAT#	A	B
88351-G	1.811	0.535
88352-G	2.043	0.531
88353-G	2.283	0.630
88354-G	2.638	0.654
88355-G	2.902	0.689
88356-G	3.374	0.669
88357-G	4.252	0.929
88358-G	4.862	0.937
88359-G	4.803	0.961
88360-G	4.803	0.961

PLASTIC INSULATING BUSHINGS



CATALOG NUMBER	TRADE SIZE	INNER CARTON	MASTER CARTON
33001	1/2"	100	1000
33002	3/4"	100	1000
33003	1"	50	500
33004	1 1/4"	25	250
33005	1 1/2"	-	50
33006	2"	-	50
33007	2 1/2"	-	25
33008	3"	-	25
33010	4"	-	10

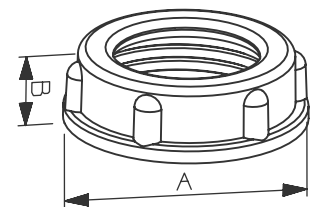

CAT#	A	B
33001	1.051	0.362
33002	1.283	0.386
33003	1.618	0.480
33004	1.902	0.567
33005	2.295	0.476
33006	2.630	0.531
33007	3.236	0.614
33008	3.911	0.677
33010	4.810	0.722

METALLIC CONDUIT BUSHING - ZINC DIE CAST



CATALOG NUMBER	TRADE SIZE	INNER CARTON	MASTER CARTON
88351	1/2"	100	1000
88352	3/4"	100	1000
88353	1"	50	500
88354	1 1/4"	25	250
88355	1 1/2"	25	250
88356	2"	25	1000
88357	2 1/2"	10	100
88358	3"	10	100
88359	3 1/2"	-	10
88360	4"	-	10

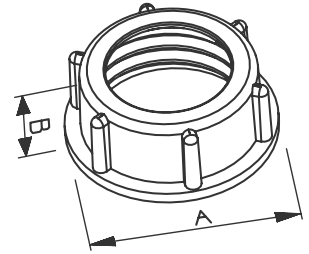

CAT#	A	B
88351	1.059	0.409
88352	1.276	0.409
88353	1.535	0.496
88354	1.888	0.539
88355	2.122	0.618
88356	2.636	0.512
88357	3.228	0.622
88358	3.823	0.827
88359	4.359	0.846
88360	4.945	0.846

CAPPED METALLIC CONDUIT BUSHING - ZINC DIE CAST



CATALOG NUMBER	TRADE SIZE	INNER CARTON	MASTER CARTON
88351-ST	1/2"	100	1000
88352-ST	3/4"	100	1000
88353-ST	1"	50	500
88354-ST	1 1/4"	25	250
88355-ST	1 1/2"	25	250
88356-ST	2"	25	100
88357-ST	2 1/2"	10	100
88358-ST	3"	10	100
88359-ST	3 1/2"	-	10
88360-ST	4"	-	10

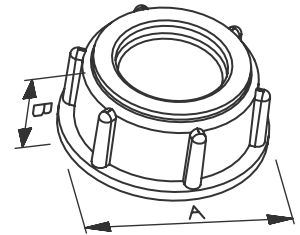

CAT#	A	B
88351-ST	1.059	0.409
88352-ST	1.276	0.409
88353-ST	1.535	0.496
88354-ST	1.888	0.539
88355-ST	2.122	0.618
88356-ST	2.636	0.512
88357-ST	3.228	0.622
88358-ST	3.823	0.827
88359-ST	4.359	0.846
88360-ST	4.945	0.846

METALLIC CONDUIT BUSHING WITH PLASTIC THROAT - ZINC DIE CAST



CATALOG NUMBER	TRADE SIZE	INNER CARTON	MASTER CARTON
88351-A	1/2"	100	1000
88352-A	3/4"	100	1000
88353-A	1"	50	500
88354-A	1 1/4"	25	250
88355-A	1 1/2"	25	250
88356-A	2"	25	100
88357-A	2 1/2"	10	100
88358-A	3"	10	100
88359-A	3 1/2"	-	10
88360-A	4"	-	10

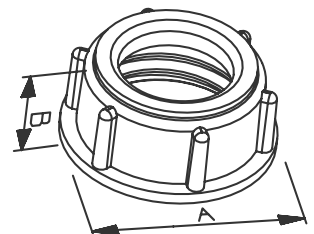

CAT#	A	B
88351-A	1.059	0.409
88352-A	1.276	0.409
88353-A	1.535	0.496
88354-A	1.888	0.539
88355-A	2.122	0.618
88356-A	2.636	0.512
88357-A	3.228	0.622
88358-A	3.823	0.827
88359-A	4.359	0.846
88360-A	4.945	0.846

WATER TIGHT HUBS - ZINC DIE CAST

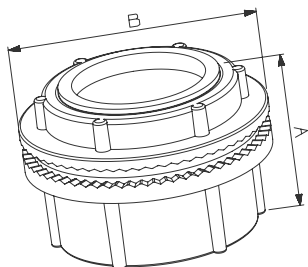

CAT#	A	B
88501	1.406	1.406
88502	1.539	1.661
88503	1.752	1.949
88504	1.689	2.409
88505	1.713	2.693
88506	1.831	3.201
88507	2.594	3.685
88508	2.614	4.385
88509	2.440	4.880
88510	2.559	5.437

CATALOG NUMBER	TRADE SIZE	INNER CARTON	MASTER CARTON
88501	1/2"	25	100
88502	3/4"	25	100
88503	1"	10	50
88504	1 1/4"	5	25
88505	1 1/2"	10	50
88506	2"	5	25
88507	2 1/2"	2	10
88508	3"	-	5
88509	3 1/2"	-	5
88510	4"	-	5



WATER TIGHT HUBS - BONDING SCREW - ZINC DIE CAST

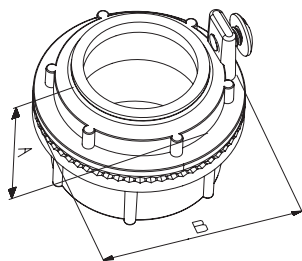

CAT#	A	B
88501-G	1.406	1.406
88502-G	1.539	1.661
88503-G	1.752	1.949
88504-G	1.689	2.409
88505-G	1.713	2.693
88506-G	1.831	3.201
88507-G	2.594	3.685
88508-G	2.614	4.385
88509-G	2.440	4.880
88510-G	2.559	5.437

CATALOG NUMBER	TRADE SIZE	INNER CARTON	MASTER CARTON
88501-G	1/2"	25	250
88502-G	3/4"	10	100
88503-G	1"	10	100
88504-G	1 1/4"	2	20
88505-G	1 1/2"	2	20
88506-G	2"	2	20
88507-G	2 1/2"	-	2
88508-G	3"	-	2
88509-G	3 1/2"	-	1
88510-G	4"	-	1



CONNECTORS FOR RIGID & IMC CONDUIT - SET SCREW TYPE - ZINC DIE CAST

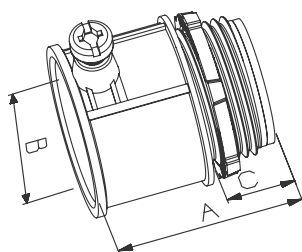

CAT#	A	B	C
88601	1.299	1.063	0.382
88602	1.492	1.338	0.437
88603	1.736	1.602	0.559
88604	-	-	-
88605	-	-	-
88606	-	-	-
88607	3.080	3.300	0.920
88608	3.370	4.010	1.050
88609	3.460	4.520	1.050
88610	3.750	5.010	1.050

CATALOG NUMBER	TRADE SIZE	INNER CARTON	MASTER CARTON
88601	1/2"	50	500
88602	3/4"	50	500
88603	1"	25	250
88604	1 1/4"	25	100
88605	1 1/2"	25	100
88606	2"	5	50
88607	2 1/2"	5	25
88608	3"	-	5
88609	3 1/2"	-	5
88610	4"	-	5





GOLDEN LIGHT FOR ELECTRICAL SUPPLIES.CO,

ADD: 8-10 ABD EL HAQ ELSOUNBATY ST,ELOBERA,CAIRO,EGYPT.

TEL: +202 23915793

FAX: +202 26566996

M: 0020 1090018260

Website: www.goldenlight-eg.com

E-mail: importing@goldenlight-eg.net

adel_goldenlight@yahoo.com

FACTORY

YINLEI ELECTRONIC. CO., LTD.

Tel: 0086-519-86470078 88171999 88129666

Fax: 0086-519-86470098 86461505

Mobile: 0086-13306147368

E-mail: yang@yinlei.com /sales01@yinlei.com

Address: No.8, W.Hexiang Rd, Wujin Economic
Development Zone, Jiangsu, China

Zip: 213149